

Drive Axles, Bearings and Joints: Service and Repair

Shaft and Axle Tube Assembly Replacement

Remove or Disconnect

- ^ Raise the vehicle and support it using safety stands.
- ^ Position a pan under the axle to catch oil.

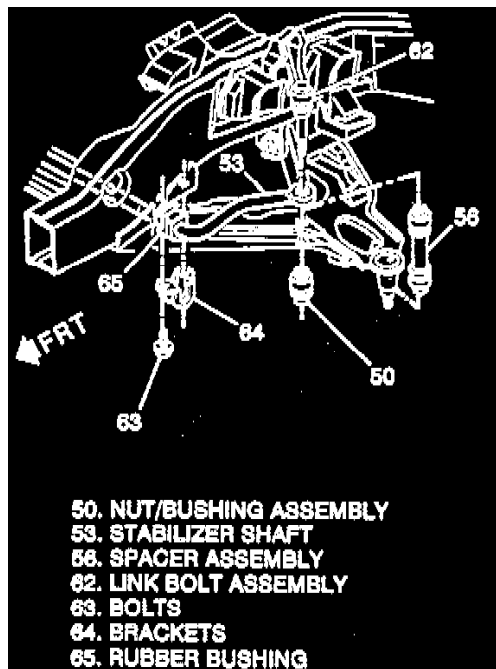

1. Bolts (63) from the left and right stabilizer brackets (64).
2. Right stabilizer link nut assembly (50), spacer (56), and link bolt assembly (62).
3. Inner tie rod end from relay rod.

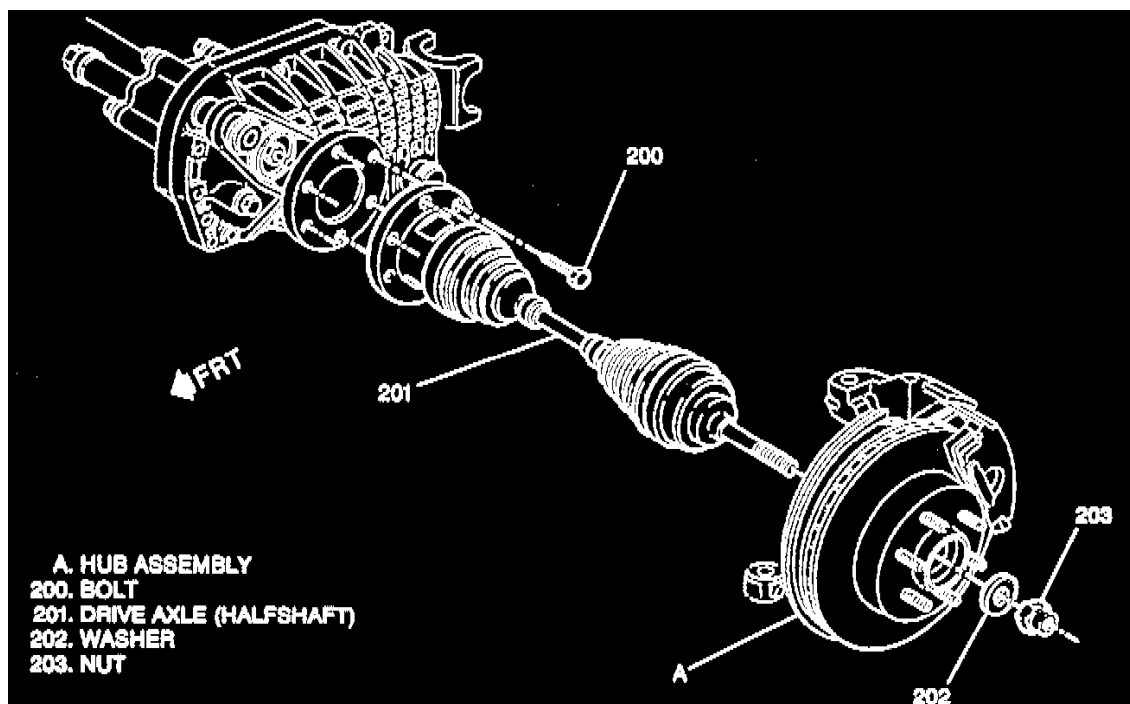

4. Axle flange bolts (200).
 - ^ Turn wheel out to loosen the drive axle from the axle tube.
 - ^ Push drive axle toward the front of the truck and tie it out of the way.

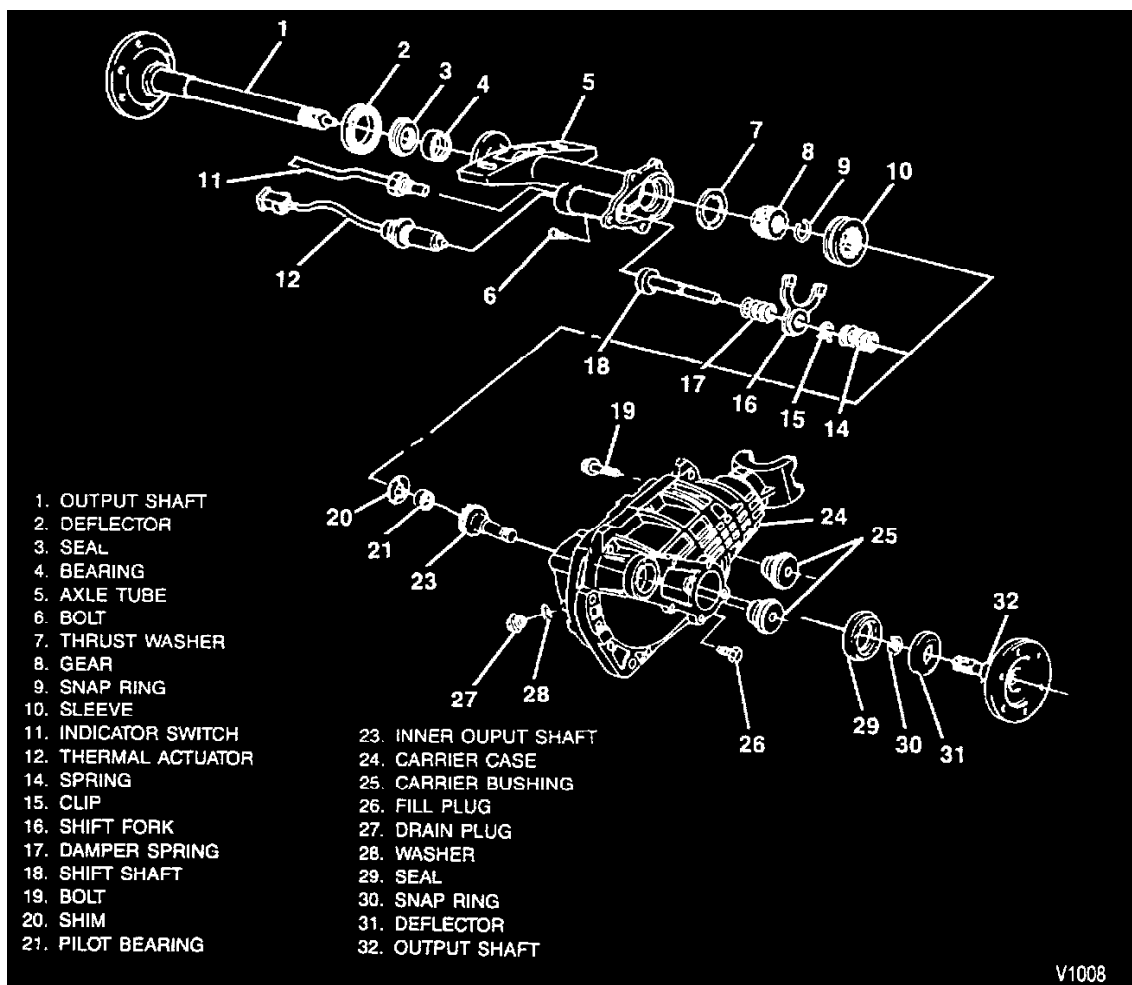

5. Actuator connector (12).
6. Indicator light connector (11).
7. Skid plate, if necessary.
8. Drain plug (27) and washer (28) from the carrier and drain the axle lubricant into a suitable container.

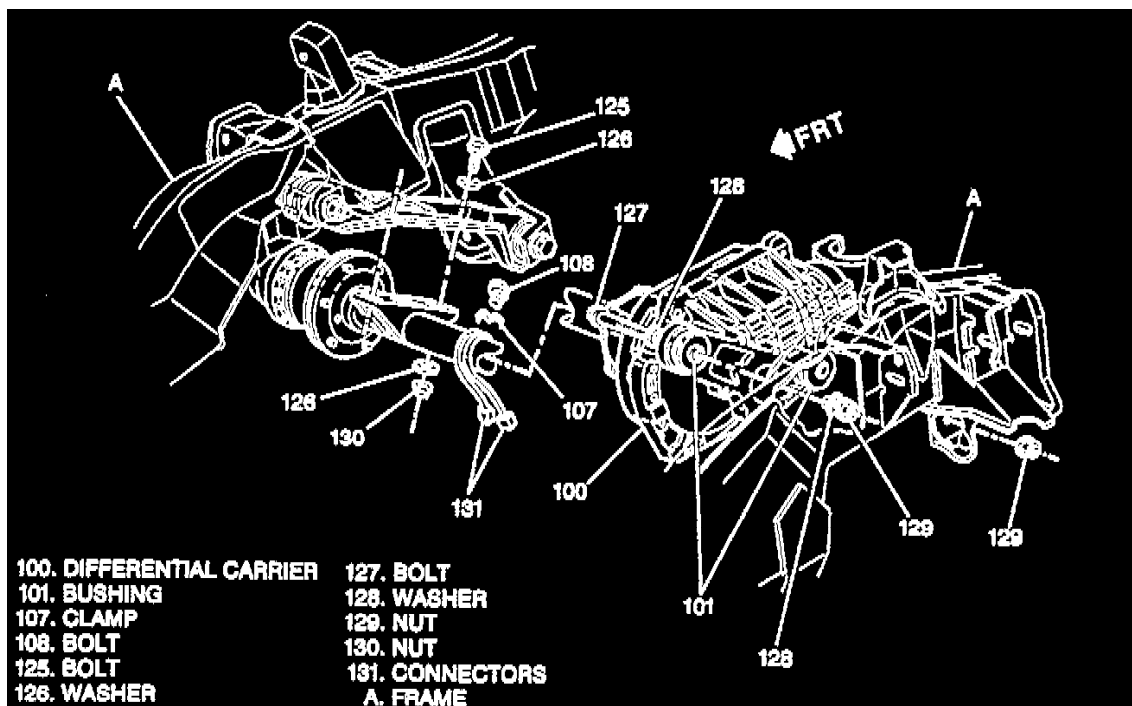

9. Axle mounting nuts (130) and washers (126).
10. Axle tube to carrier bolts (6).
11. Axle tube from carrier.

- ^ Take care to keep the open end of the tube up.

Disassemble

Tools Required:

- ^ J 29369-1 Bearing Remover (K1/2 models)
 - ^ J 29369-2 Bearing Remover (K3 models)
- ^ Hold the axle tube in a vise by the mounting flange.
1. Sleeve (10).
 2. Gear (8).
 3. Thrust washer (7).
 4. Axle shaft (1). Tap out with a soft mallet.
 5. Deflector (2). Pry out with a screwdriver.
 6. Seal (3). Pry out with a screwdriver.
 7. Bearing (4). Use J 29369-1 (K1/2 models) or J 29369-2 (K3 models) and a slide hammer.

Clean

- ^ Parts in a suitable solvent.
- ^ Gasket surfaces on the axle tube and carrier housing.

Assemble

Tools Required:

- ^ J 36609 Bearing Installer
 - ^ J 36600 Seal Installer (K1/2 Models)
 - ^ J 22833 Seal Installer (K3 Models)
1. New bearing (4). Use J 36609. Apply axle lubricant to the bearing.
 2. New seal (3). Use J 36600 (K1/2 models) or J 22833 (K3 models). Coat the seal lips with grease.
 3. Deflector (2).
 4. Axle shaft (1).
 5. Thrust washer (7). Use grease to hold it in place. Make sure the tabs on the washer align with the slot in the axle tube.
 6. Gear (8).
 7. Sleeve (10).

Install or Connect

- ^ Apply sealant (Loctite 518 [GM P/N 1052942] or equivalent) to the carrier sealing surface.

1. Axle tube (5) to carrier (24).
2. Bolts (6).

Tighten

- ^ Bolts to **40 N.m (30 lbs. ft.)**.

3. Drive shaft to axle shaft.
4. Bolts (200).

Tighten

- ^ Bolts to **80 N.m (59 lbs. ft.)**.

5. Axle mounting nuts (130) with washers (126).

Tighten

- ^ Nuts (130) to specifications:
 - K1/2 models: **100 N.m (75 lbs. ft.)**.
 - K3 models: **145 N.m (106 lbs. ft.)**.

6. Tie rod end to relay rod.
7. Stabilizer link (62).

Tighten

- ^ Nut to **18 N.m (13 lbs. ft.)** until the nuts meet the end of the bolt threads for torque value.

8. Stabilizer bracket to frame nuts (63).

Tighten

^ Bolts to **33 N.m (24 lbs. ft.)**.

9. Actuator connector (12).
10. Indicator connector (11).
11. Drain plug (27) and the washer (26).

Tighten

^ Plug to **33 N.m (24 lbs. ft.)**.

12. New lubricant.
13. Fill plug (26).

Tighten

^ Plug to **33 N.m (24 lbs. ft.)**.

14. Skid plate, if necessary.